

Course	Distance	
N 7 W	80.00	Set post marked 3 m
" " "	35.00	Angle thence
N 20 W	61.00	" "
North	75.00	" "
N 7 W	80.00	Set post marked 4 m
" " "	20.00	Angle thence
North	41.00	" "
N 15° E	48.50	" "
N 3 E.	60.00	Schose House bears East 4.00 chs
" " "	65.00	Angle thence <sup>2nd</sup> intersect road
N 37 W	80.00	Set post marked 5 m.
N 26 E	30.50	Angle thence
N 37 W	43.00	" "
N 32 W	80.00	Set post marked 6 m.
" " "	4.00	Angle thence
N 25 W	16.00	Intersect road leading from the State Line to Geer Springs <sup>2nd</sup> planted a post marked R.

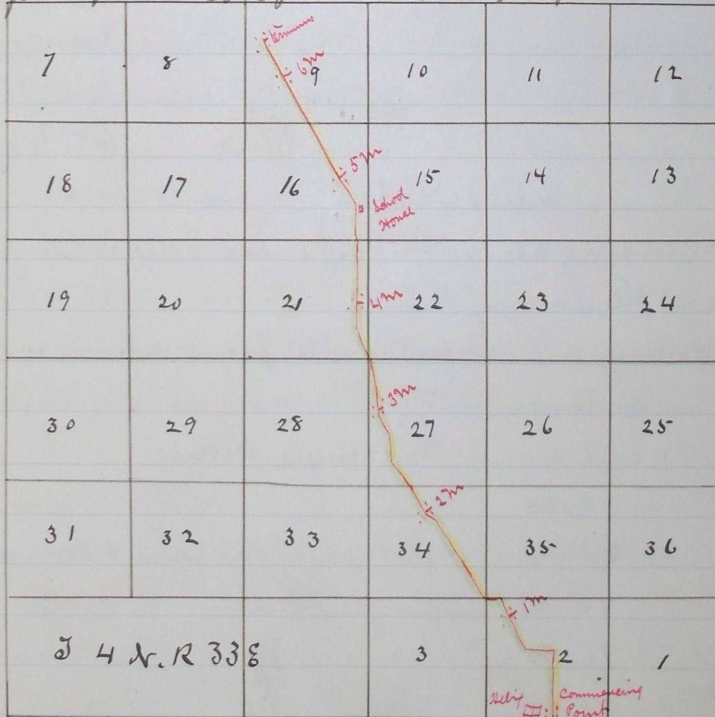

T 5 N. R 33 E. W. 7 m

Journal of Page 133  
 " of " 223  
 Recorded March 3 / 1883  
 J. P. Bushie  
 County Clerk

I hereby certify that the within is a true  
 and correct plat <sup>2nd</sup> survey the above named  
 Road this 10 day of August 1883.  
 A. L. Coffey  
 County Surveyor  
 of Umatilla Co. Oregon