

- 14314 Drive stake for temp center sec 1 in thick brush & timber
- 73111 Set angle stake and turn through dense brush 32° S
- 7541 " " " " " 32° R Through brush more open
- 3358 " " " " " 32° R " Thick brush
- 4098 " " " " " 32 L Through timber & brush
- 4519 Probable 1/2 deer bat sees 196 in open brush
- 5280 A Red fir 14" dia on line cut 4 m on South side and 3 no other E.S.W. I continue East on random center sec 6 & 3 NR 37E brush very thick
- 3788 An exceedingly brushy ravine runs S
- 4018 Set angle post and turn S 19° Through heavy brush
- 4548 An original 1/2 ac bearing tree - brush cleared away
- 4568 A Sawraek 14 1/2 dia marked R 337 for terminus of road Brush cleared away so that I can see Doble's Saw mill which I find to be 150 East of terminus. I have heard the sound of the saw for 200 or 300 ft back in the brush This is an extremely brushy road

I hereby certify that the foregoing are the correct field notes of the survey of road No 337 for Umatilla Co Or the brushiest road I ever was on  
 Geo. L. Arnold Surveyor.

Filed July 10-1890 }  
 W. M. Pierce Clerk

I hereby certify the following to be a correct plat of the survey of Road 337 Township 37 N Range 36 & 37 East of the Willamette Meridian as made by me  
 June 28-29, 30-1890.  
 Geo. L. Arnold  
 Surveyor for Umatilla County Oregon

→ Plat of Survey of Road No 337 ←

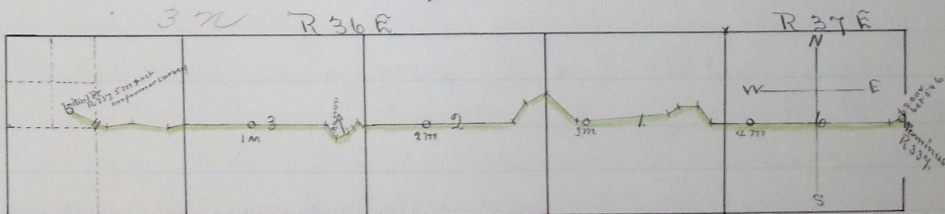

Filed July 10 1890 }  
 W. M. Pierce Clerk

July 16 1890 H 593